



HOOGHLY RIVER BRIDGE COMMISSIONERS

(A STATUTORY ORGANISATION UNDER GOVT. OF WEST BENGAL)

HRBC BHAVAN

ST. GEORGES GATE ROAD (MUNSHI PREM CHAND SARANI)

KOLKATA-700 021

Ph. No.: 033-2248 5833/2253-4133; email: direc.pldn@gmail.com

CORRIGENDUM-1, dated 20.08.2025

Tender ID 2025_HRBC_890316_2

Notice Inviting e-Tender No.. HRBC/02/DIRPLDN/25-26 vide memo no.: HRBC/12C-338/2025/120825-1 dated 12.08.2025

Sl.No.	Location in Tender Document	In place of	To be read as
1.	In the first page of NleT in list of scheme Sl.No. 1	Period of Completion: 10 (eight) months	Period of Completion: 10 (ten) months
2.	Section C: Tender Drawings	No drawings for the site of Sl. No. 2, i.e., Nonadanga, Kolkata	Tender-purpose drawings for the site of Sl.No. 2, i.e., Nonadanga, Kolkata are inserted .

The Corrigendum-1 as above is issued in terms of Clause A.6.3 of Section A: Instructions to Bidders and will be a part of the Bid Document.

.....
Director (Pl.& Dn.), HRBC

Seal and Signature of the Tenderer

Director (Pr & Co), HRBC

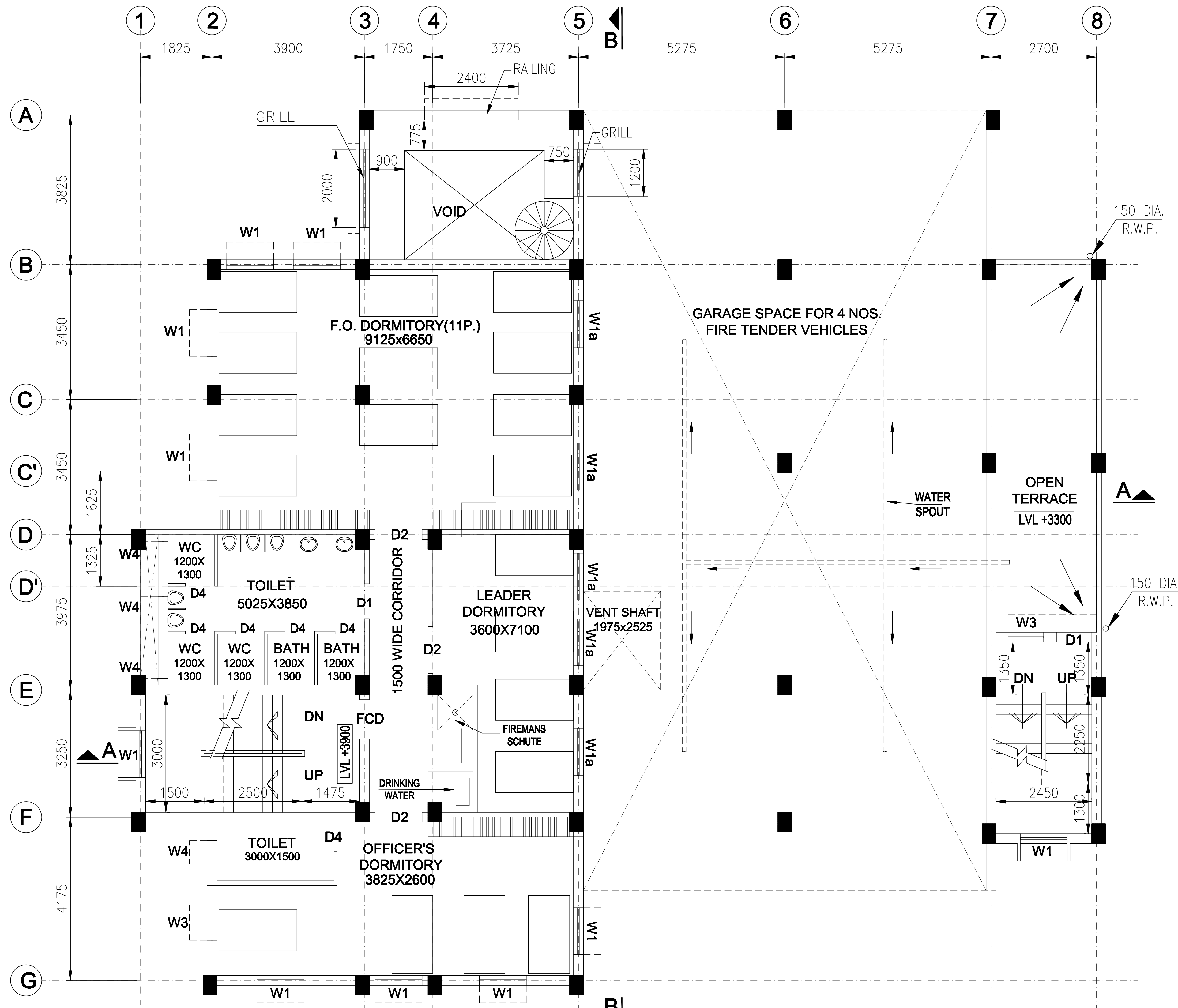

FIRST FLOOR PLAN

TENDERING PURPOSE ONLY

GENERAL NOTES

1. ALL DIMENSIONS ARE IN MM UNLESS MENTIONED OTHERWISE.
2. ONLY WRITTEN DIMENSIONS TO BE FOLLOWED.
3. ALL DRAWING DIMENSIONS (INCLUDING LEVELS) TO BE CHECKED AT SITE, IN CASE OF ANY DISCREPANCY REPORT TO THIS OFFICE IMMEDIATELY.
4. THIS DRAWING HARD COPIES SUPPLIED BY THE DEPARTMENT.

AREA STATEMENT

BUILT UP AREA

GROUND FLOOR: 234.50 SQ.M.
FIRST FLOOR: 207.00 SQ.M.
SECOND FLOOR: 110.00 SQ.M.

TOTAL B/U AREA = 551.50 SQ.M.

P.E.B. COVERED AREA

9.20 M X 10.30 M = 94.76 SQ.M.

O.C. QUARTER AREA:

CARPET AREA : 80 SQ.M. (861.00 SQ.FT.)
(EXCLUDING STAIRCASE)

COVERED AREA : 94.00 SQ.M. (1011.00 SQ.FT.)
(EXCLUDING STAIRCASE)

SCHEDULE OF DOORS

MARK	WIDTH	HEIGHT	TYPE
D1	900	2100	WOODEN FLUSH DOOR
D2	1200	2100	WOODEN FLUSH DOOR
D3	750	2100	WOODEN FLUSH DOOR
D4	750	2100	PVC DOOR
FCD	1000	2100	2 HRS FIRE RATED DOOR
RS1	1500	2100	ROLLING SHUTTER
RS2	1800	2100	ROLLING SHUTTER

SCHEDULE OF WINDOWS

MARK	WIDTH	HT.	SILL	TYPE
W1	1200	1200	900	ALL FRAMED SLIDING
W1a	1200	SOFFIT OF BEAM	1200	ALL FRAMED SLIDING
W2	2750	2100	2100	ALL FRAMED SLIDING
W3	900	1200	900	ALL FRAMED SLIDING
W4	600	600	1500	ALL FRAMED SLIDING

SL.NO.	DATE	DESCRIPTION	SIGNATURE
--------	------	-------------	-----------

REVISION SCHEDULE

EXECUTING AGENCY :

HOOGHLY RIVER BRIDGE COMMISSIONERS

(A STATUTORY ORGANISATION UNDER GOVT. OF WEST BENGAL)

HRBC BHAVAN

ST. GEORGES GATE ROAD (MUNSHI PREM CHAND SARANI)
KOLKATA-700 021

PROJECT : PROPOSED NEW (G+I)
STORIED 2 PUMP FIRE STATION WITH
(G+II) STORIED FOUNDATION AT
NONADANGA IN KOLKATA, WEST BENGAL

PROJECT CONSULTANTS:

C.S. CONSULTANT

Registered Address :-

88/D, Word No.-05, S.Majumdar Road, Shanti Colony,
Kalyaganj, Uttar Dinajpur, WB-733129.

City Office :-

GA-40, Rajdanga Main Road, Kasba, Kolkata - 700107.

E-mail :- csc.consultancy2011@gmail.com

Telephone :-+91 7872504393, 9807915296.

TITLE : FIRST FLOOR PLAN

SCALE : 1 : 100	CSC/HRBC/GAZOLE/ARCHI/02	REV.
DATE : JUL, 2025		RO

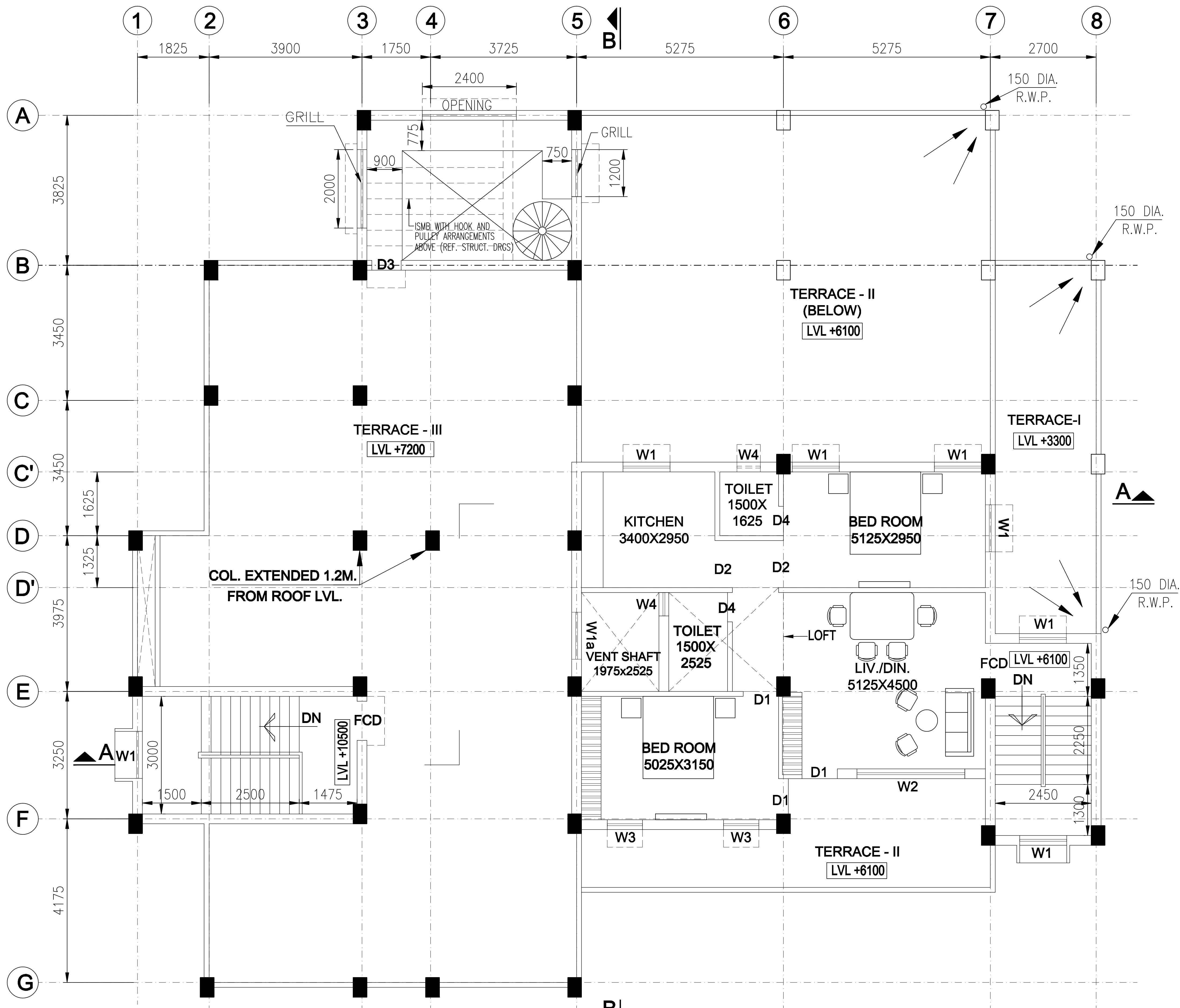

2ND FLOOR PLAN

TENDERING PURPOSE ONLY

GENERAL NOTES

1. ALL DIMENSIONS ARE IN MM UNLESS MENTIONED OTHERWISE.
2. ONLY WRITTEN DIMENSIONS TO BE FOLLOWED.
3. ALL DRAWING DIMENSIONS (INCLUDING LEVELS) TO BE CHECKED AT SITE, IN CASE OF ANY DISCREPANCY REPORT TO THIS OFFICE IMMEDIATELY.
4. THIS DRAWING HARD COPIES SUPPLIED BY THE DEPARTMENT.

AREA STATEMENT

BUILT UP AREA

GROUND FLOOR: 234.50 SQ.M.
FIRST FLOOR: 207.00 SQ.M.
SECOND FLOOR: 110.00 SQ.M.

TOTAL B/U AREA = 551.50 SQ.M.

P.E.B. COVERED AREA

9.20 M X 10.30 M = 94.76 SQ.M.

O.C. QUARTER AREA:

CARPET AREA : 80 SQ.M. (861.00 SQ.FT.)
(EXCLUDING STAIRCASE)
COVERED AREA : 94.00 SQ.M. (1011.00 SQ.FT.)
(EXCLUDING STAIRCASE)

SCHEDULE OF DOORS

MARK	WIDTH	HEIGHT	TYPE
D1	900	2100	WOODEN FLUSH DOOR
D2	1200	2100	WOODEN FLUSH DOOR
D3	750	2100	WOODEN FLUSH DOOR
D4	750	2100	PVC DOOR
FCD	1000	2100	2 HRS FIRE RATED DOOR
RS1	1500	2100	ROLLING SHUTTER
RS2	1800	2100	ROLLING SHUTTER

SCHEDULE OF WINDOWS

MARK	WIDTH	HT.	SILL	TYPE
W1	1200	1200	900	ALL FRAMED SLIDING
W1a	1200	SOFFIT OF BEAM	1200	ALL FRAMED SLIDING
W2	2750	2100	2100	ALL FRAMED SLIDING
W3	900	1200	900	ALL FRAMED SLIDING
W4	600	600	1500	ALL FRAMED SLIDING

SL.NO.	DATE	DESCRIPTION	SIGNATURE
--------	------	-------------	-----------

REVISION SCHEDULE

EXECUTING AGENCY :

HOOGHLY RIVER BRIDGE COMMISSIONERS
(A STATUTORY ORGANISATION UNDER GOVT. OF WEST BENGAL)
HRBC BHAVAN

ST. GEORGES GATE ROAD (MUNSHI PREM CHAND SARANI)
KOLKATA-700 021

PROJECT :

**PROPOSED NEW (G+I)
STORIED 2 PUMP FIRE STATION WITH
(G+II) STORIED FOUNDATION AT
NONADANGA IN KOLKATA, WEST BENGAL**

PROJECT CONSULTANTS:

C.S. CONSULTANT

Registered Address :-

88/D, Word No.-05, S.Majumdar Road, Shanti Colony,
Kaliyaganj, Uttar Dinajpur, WB-733129.

City Office :-

GA-40, Rajdanga Main Road, Kasba, Kolkata - 700107.

E-mail :- csc.consultancy2011@gmail.com

Telephone :+91 7872504393, 9807915296.

TITLE :

2ND FLOOR PLAN

SCALE : 1 : 100
DATE : JUL, 2025

CSC/HRBC/GAZOLE/ARCHI/03

REV.
RO

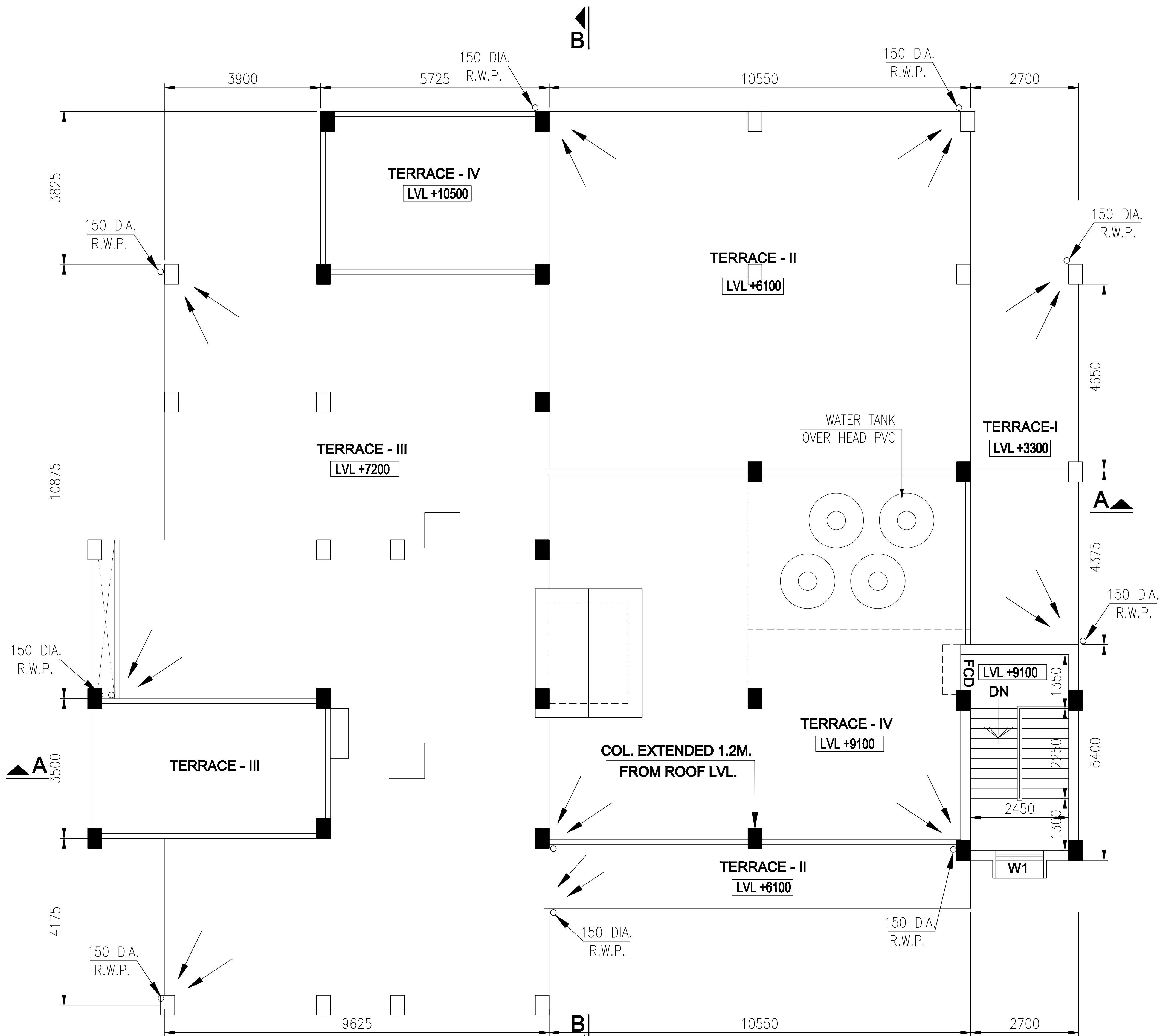

ROOF PLAN

TENDERING PURPOSE ONLY

GENERAL NOTES

1. ALL DIMENSIONS ARE IN MM UNLESS MENTIONED OTHERWISE.
2. ONLY WRITTEN DIMENSIONS TO BE FOLLOWED.
3. ALL DRAWING DIMENSIONS (INCLUDING LEVELS) TO BE CHECKED AT SITE, IN CASE OF ANY DISCREPANCY REPORT TO THIS OFFICE IMMEDIATELY.
4. THIS DRAWING HARD COPIES SUPPLIED BY THE DEPARTMENT.

AREA STATEMENT

BUILT UP AREA

GROUND FLOOR: 234.50 SQ.M.
FIRST FLOOR: 207.00 SQ.M.
SECOND FLOOR: 110.00 SQ.M.

TOTAL B/U AREA = 551.50 SQ.M.

P.E.B. COVERED AREA

9.20 M X 10.30 M = 94.76 SQ.M.

O.C. QUARTER AREA:

CARPET AREA : 80 SQ.M. (861.00 SQ.FT.)
(EXCLUDING STAIRCASE)

COVERED AREA : 94.00 SQ.M. (1011.00 SQ.FT.)
(EXCLUDING STAIRCASE)

SCHEDULE OF DOORS

MARK	WIDTH	HEIGHT	TYPE
D1	900	2100	WOODEN FLUSH DOOR
D2	1200	2100	WOODEN FLUSH DOOR
D3	750	2100	WOODEN FLUSH DOOR
D4	750	2100	PVC DOOR
FCD	1000	2100	2 HRS FIRE RATED DOOR
RS1	1500	2100	ROLLING SHUTTER
RS2	1800	2100	ROLLING SHUTTER

SCHEDULE OF WINDOWS

MARK	WIDTH	HT.	SILL	TYPE
W1	1200	1200	900	ALL FRAMED SLIDING
W1a	1200	SOFFIT OF BEAM	1200	ALL FRAMED SLIDING
W2	2750	2100	2100	ALL FRAMED SLIDING
W3	900	1200	900	ALL FRAMED SLIDING
W4	600	600	1500	ALL FRAMED SLIDING

SL.NO.	DATE	DESCRIPTION	SIGNATURE
--------	------	-------------	-----------

REVISION SCHEDULE

EXECUTING AGENCY :
HOOGHLY RIVER BRIDGE COMMISSIONERS
(A STATUTORY ORGANISATION UNDER GOVT. OF WEST BENGAL)
HRBC BHAVAN
ST. GEORGES GATE ROAD (MUNSHI PREM CHAND SARANI)
KOLKATA-700 021

PROJECT : **PROPOSED NEW (G+I)
STORIED 2 PUMP FIRE STATION WITH
(G+II) STORIED FOUNDATION AT
NONADANGA IN KOLKATA, WEST BENGAL**

PROJECT CONSULTANTS:
C.S. CONSULTANT
Registered Address :-
88/D, Word No.-05, S.Majumdar Road, Shanti Colony,
Kalyaganj, Uttar Dinajpur, WB-733129.
City Office :-
GA-40, Rajdanga Main Road, Kasba, Kolkata - 700107.
E-mail :- csc.consultancy2011@gmail.com
Telephone :+91 7872504393, 9907915296.

TITLE : **ROOF PLAN**

SCALE : 1 : 100	CSC/HRBC/GAZOLE/ARCHI/04	REV.
DATE : JUL, 2025		RO